

**UNAFLEX MATCHLESS BELLOWS EXPANSION JOINTS
LONG STYLE SPECIFICATION CHART FOR
STYLE 22**

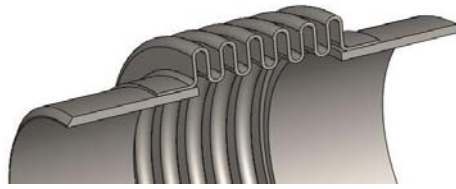

Nominal Size (in.)	Series	Pressure (psig.)	O.A.L. (in.)	Weight (lbs.)	Non-concurrent Movements (in.)			Spring Rates (lbs./in.)	
					Compression	Extension	Lateral	Axial	Lateral
2	LLP	50	10	2	1.60	0.40	0.5	389	180
	LMP	150		6	0.96	0.24	0.3	483	219
	LHP	300		6			0.3	1,052	471
2.5	LLP	50	10	2	1.60	0.40	0.5	279	105
	LMP	150		2	1.20	0.30	0.3	688	253
	LHP	300		3			0.2	1,403	896
3	LLP	50	10	3	1.60	0.40	0.6	312	166
	LMP	150		4	1.20	0.30	0.4	721	379
	LHP	300		3			0.3	1,474	778
3.5	LLP	50	10	3	1.60	0.40	0.6	336	228
	LMP	150		5	1.28	0.32	0.4	589	686
	LHP	300		5			0.3	1,209	1,284
4	LLP	50	10	4	1.60	0.40	0.6	378	342
	LMP	150		4	1.28	0.32	0.4	743	671
	LHP	300		5			0.3	1,564	1,412
5	LLP	50	14	9	2.40	0.60	0.5	242	249
	LMP	150		9	1.60	0.40	0.5	922	862
	LHP	300		10			0.4	1,760	1,601
6	LLP	50	14	11	2.40	0.60	0.75	260	369
	LMP	150		12	1.76	0.44	0.6	762	1,003
	LHP	300		14			0.45	1,924	2,292
8	LLP	50	17	21	3.20	0.80	0.75	541	951
	LMP	150		23	2.08	0.52	0.55	1,014	1,788
	LHP	300		23			0.4	1,846	3,240
10	LLP	50	17	29	3.20	0.80	0.6	263	856
	LMP	150		34	2.08	0.52	0.45	984	3,344
	LHP	300		33			0.3	2,318	6,826
12	LLP	50	17	30	3.20	0.80	0.8	335	1,015
	LMP	150		34	2.08	0.52	0.5	1,144	3,311
	LHP	300		40			0.3	11,532	3,971
14	LLP	50	17	25	2.88	0.72	0.7	359	1,291
	LMP	150		31			0.5	1,055	3,850
	LHP	300		45			0.4	2,373	8,924
16	LLP	50	17	29	2.88	0.72	0.7	362	1,676
	LMP	150		35			0.4	1,362	6,318
	LHP	300		50			0.4	3,054	14,233
18	LLP	50	17	33	2.88	0.72	0.5	419	2,415
	LMP	150		39			0.35	1,588	9,163
	LHP	300		61			0.3	3,257	19,258
20	LLP	50	17	40	2.88	0.72	0.4	428	3,761
	LMP	150		46			0.3	1,721	14,290
	LHP	300		70			0.3	3,134	26,708
22	LLP	50	18	47	2.88	0.72	0.6	346	3,068
	LMP	150		57			0.25	2,730	24,241
	LHP	300		83			0.25	6,012	49,988
24	LLP	50	18	65	2.88	0.72	0.2	641	10,432
	LMP	150		71			0.2	2,531	38,408
	LHP	300		97			0.2	4,970	75,699
30	DS	50	18	130	3.20	0.80	0.2	960	64,500
36				157				1,160	132,000
40				173				1,300	158,000
42	DS	50	18	182	3.20	0.80	0.2	1,186	230,000
46				200				1,244	260,000
48				210				2,400	368,000
50	DS	25	18	220	3.20	0.80	0.3	1,440	45,500
52				250				2,200	80,100
54				265				2,290	90,900
60	DS	25	18	288	3.20	0.80	0.2	2,580	115,000
66				350				2,840	150,500
72				380				3,100	225,000
84	DS	15	18	490	3.20	0.80	0.15	3,610	1,500,000
96				640				4,150	1,900,000
108				660				4,670	2,300,000
126	DS	15	18	730	3.20	0.80	0.1	5,100	2,800,000
132				810				5,650	3,200,000
144				900				6,100	3,600,000